

State of South Carolina 96 District (21)

East of the ancient Boundary line Pursuant to a warrant from John Thomas Esq. Commissioner of Locations bearing date the 29<sup>th</sup> day of July 1784. I have admeasured and laid out unto Nehemiah Miller a tract of land containing one hundred & thirty one acres lying and being on both sides of Browns Creek bound ad, to the East by Hugh Niffensland to the West by Joseph Robinson Land, all other sides old lines and vacant land, including the improvement on which the said Nehemiah Miller now lives and hath such stake and marks as the annexed plat represents. Survey the 29<sup>th</sup> day of July 1784. - - - - - Contained by - - - - - Andrew Thomson Esq.

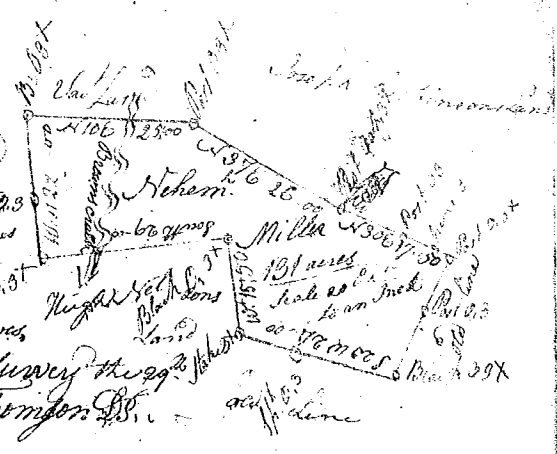

Recorded the 26<sup>th</sup> of Nov<sup>r</sup> 1784

State of South Carolina Ninety six District, on the East side of the ancient boundary line Pursuant to a warrant from John Thomas Esq. Commissioner of Locations on the north side of Saluda River. Bearing date the 21<sup>st</sup> July 1784. I have admeasured and laid out unto Thomas Young a Tract of land containing five hundred & fifty acres lying on Bufflow creek a branch of fairforest. Bounded to the S. by vacant land to the East by Bogans land & old lines NE by Eph. Hodges Beth W. by Turner Down. Trus & James Woodsons & Col Thomas Brandon's lands, & hath such stake & marks as the annexed plat represents. Survey the 21<sup>st</sup> Aug<sup>t</sup> 1784

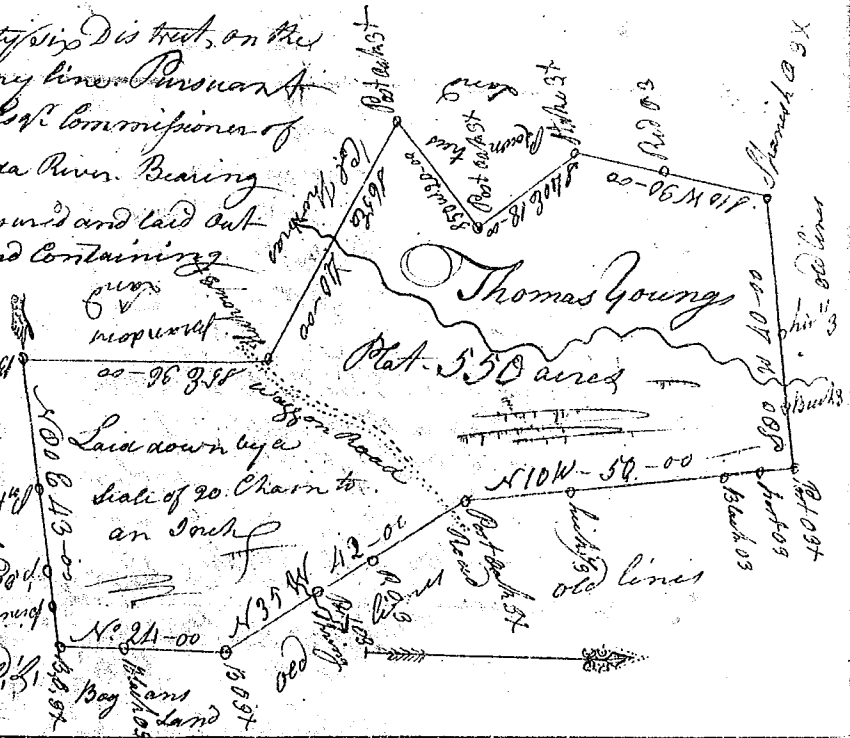

Recorded the 26<sup>th</sup> Nov<sup>r</sup> 1784

State of South Carolina 96 District East of the ancient Boundary line Pursuant to a warrant from John Thomas Esq. Commissioner of Locations on the North side of Saluda. Bearing date the 14<sup>th</sup> day of August 1784. I have admeasured & laid out unto Robert Lusk, a Tract of land containing four hundred acres, lying on the S. side of The pretty creek on a branch called Diehs branch, Bounded N. by Joseph Jolly Esq. by Moses Macks S. by Turners land W. by Vank and hath such stake and marks as the annexed plat represents. Survey the 18<sup>th</sup> Aug<sup>t</sup> 1784 By

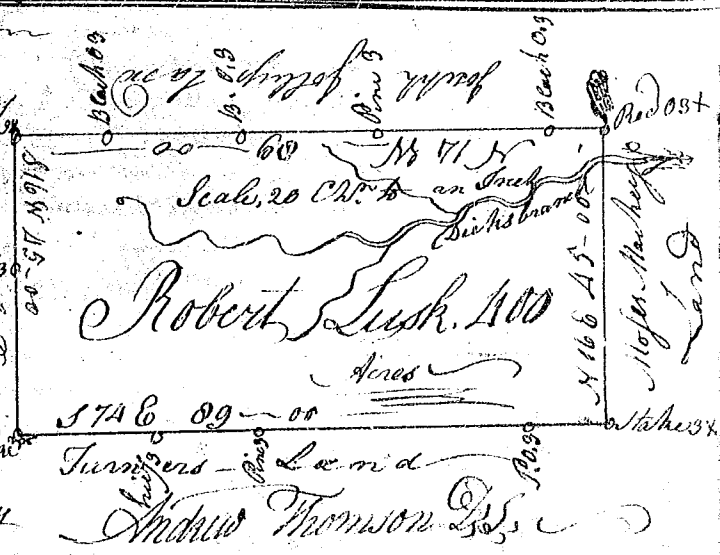

Recorded the 26<sup>th</sup> Nov<sup>r</sup> 1784

State of South Carolina Pursuant to a warrant from John Thomas Esq. Commissioner of Locations. I have admeasured and laid out unto John Hughey a tract of 160 acres of land, situated in 96 District on the waters of Sugar River bounding S. E. on land laid out upon land laid out NW on land laid out & SW on land laid out & hath such stake and marks as the annexed plat represents. Survey the 28<sup>th</sup> Aug<sup>t</sup> 1784

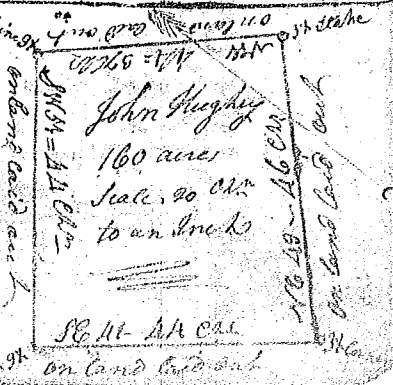

Recorded the 26<sup>th</sup> Nov<sup>r</sup> 1784